

mantra

EVENTS YOUR WAY

MANTRA PARRAMATTA
CONFERENCE AND EVENTS



HOTEL FACILITIES



LOCATION

Located right at the centre of Parramatta's business district, within easy reach of shopping, dining and entertainment, Mantra Parramatta Hotel offers apartment style accommodation perfect for a short business trip or extended holiday.

Located 40 minutes from Sydney Airport and 30 minutes from the Sydney CBD, Mantra Parramatta Hotel offers a variety of self-contained rooms and apartments all with kitchenette facilities, dedicated work spaces and internet access.

Whether you are visiting Mantra Parramatta accommodation for business or pleasure, our friendly and knowledgeable staff will be there to assist you, day or night with 24-hour reception.

Mantra Parramatta's very own Social House Dining & Bar provide the perfect setting for a wholesome breakfast or a quiet dinner for two with their innovative menu and extensive wine list to match.

For business travellers, Mantra Parramatta boasts modern and stylish conferencing facilities including a professional boardroom and three flexible function rooms. Catering to as many as 180 delegates and with experience events staff Mantra Parramatta is a leader in Sydney conferences.

The greater Parramatta area offers an abundance of recreational and retail activities and with the bus and train interchange just 100 metres from the hotel it's all easily accessible. Stop by Olympic Park at Homebush, Qudos Bank Arena, Rosehill Racecourse or get lost in the many department stores and boutiques of Westfield Parramatta – Australia's third largest shopping centre.



FACILITIES

At Mantra Parramatta we deliver a variety of services to ensure the comfort and well-being of our guests.

Services include 24-hour reception, secure undercover parking, in-room internet access, express checkout and a conferencing centre.

Leisure facilities offered include a pool and a fully equipped gymnasium.

For dining convenience Mantra Parramatta offers the Social House Dining & Bar which deliver a modern Australian menu and extensive wine list in a warm and relaxed atmosphere.



CONFERENCE ROOMS CAPACITIES



We offer a choice of four flexible function rooms at Mantra Parramatta, perfect for a range of function sizes and set-ups

BRONZE FUNCTION ROOM

If you're looking for a function space that can accommodate up to 50 people in a theatre style set-up, the Bronze Room is ideal. The smallest of our function rooms, it provides a calming atmosphere for gatherings such as training sessions, interviews, small product launches or board meetings.



SILVER FUNCTION ROOM

Just slightly larger than the Bronze Room, our Silver Room suits meetings of up to 50 people in a theatre style arrangement or 22 people in a U-style conference.

GOLD FUNCTION ROOM

The largest of the individual function rooms, our Gold Room holds up to 60 people in a theatre arrangement or 25 for a U-style meeting.



MEDALS FUNCTION ROOM

Our largest function space is the Medals Room, formed by joining all the other function spaces together. Catering for up to 180 delegates in a theatre style

FLOOR PLAN AND ROOMS CAPACITIES

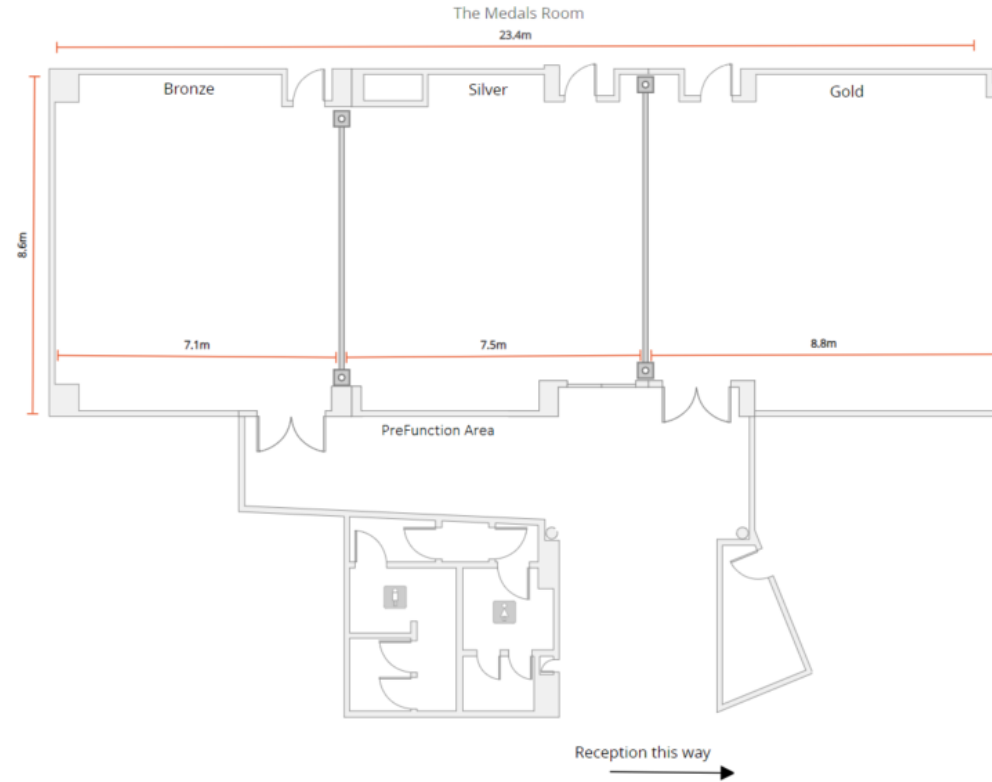

ROOM CAPACITIES

| Room | Size m2 | Theatre | Classroom | U-shape | Cabaret | Boardroom | Banquet | Cocktail |
|-----------------------------|---------|---------|-----------|---------|---------|-----------|---------|----------|
| Bronze | 61 | 50 | 24 | 22 | 32 | 20 | 40 | 50 |
| Silver | 64 | 60 | 24 | 22 | 32 | 20 | 40 | 50 |
| Gold | 75 | 60 | 30 | 24 | 32 | 23 | 50 | 60 |
| Gold & Silver | 140 | 130 | 70 | 40 | 64 | 35 | 80 | 150 |
| Silver & Bronze | 125 | 120 | 60 | 35 | 56 | 30 | 70 | 130 |
| The Medals | 201 | 180 | 100 | - | 104 | - | 130 | 180 |
| Social House Dining | | - | - | - | - | - | 70 | 100 |
| Social House Dining and Bar | | - | - | - | - | - | 150 | 200 |

HALF AND FULL DAY EXPERIENCES



Mantra Parramatta Hotel is proud to offer the following Day Delegate Packages for your next event.

FULL DAY DELEGATE PACKAGE - \$79 PER PERSON *

Arrival tea and coffee - Nespresso coffee and an assortment of teas
Morning tea and afternoon tea - 2 Gourmet food items served at each break with Nespresso coffee and assorted teas
Buffet lunch served at the restaurant. Includes a variety of hot, cold and dessert items (subject to min numbers)
Complimentary Full day room hire *
Mantra stationery - pads and pens
Iced water on the tables
Standard audio visual equipment
Full day room hire is considered to be 8am - 5pm

HALF DAY DELEGATE PACKAGE - \$72 PER PERSON *

Arrival tea and coffee - Nespresso coffee and an assortment of teas
Morning tea or afternoon tea - 2 Gourmet food items with Nespresso coffee and assorted teas
Buffet lunch served at the restaurant. Includes a variety of hot, cold and dessert items (subject to min numbers)
Complimentary Half day room hire *
Mantra stationery - Notepads and pens
Iced water on the tables
Standard audio visual equipment

*Prices Valid till 31st December 2025

Full day room hire is considered to be 8am - 5pm. Half day room hire is considered to be 8am - 12pm or 1pm 5pm.

All prices are based on minimum of 20 delegates. For delegate numbers less than the minimum required, please contact a member of our Meetings and Events Team to discuss options and pricing. Minimum spends apply.

Standard audio visual equipment include whiteboard and markers, flip chart and makers, data projector screen and welcome signage.

"Our menu and kitchen contains multiple allergens and foods which may cause an intolerance. Our team will make efforts to accommodate dietary requirements for your event, including the preparation of select dishes without the addition of certain allergens on request. However due to the shared production and serving environment, we cannot guarantee the complete omission of such allergens or foods which may cause an intolerance. You are responsible for ensuring all event attendees who indicate dietary requirements (including allergens and intolerances) are clearly informed of this."



REJUVENATION BREAKS



ARRIVAL BREAKFAST - FROM \$25 PER PERSON *

Ham and cheese croissants
Bacon and egg roll
Selection of danishes and pastries
Seasonal fruit selection
Nespresso coffee, premium teas and herbal infusions
Orange juice

ARRIVAL TEA AND COFFEE - \$6.5 PER PERSON *

Nespresso coffee and assorted teas



CONTINUOUS TEA AND COFFEE - FROM \$9 PER PERSON *

Nespresso coffee and assorted teas served throughout the duration of the function.
Half Day \$9 per person OR Full Day \$11 per person

LUNCH PACKAGE - FROM \$35 PER PERSON *

Nespresso coffee and assorted teas, served with Chef's selection of Lunch

MORNING OR AFTERNOON TEA BREAK - FROM \$18 PER PERSON *

Nespresso coffee and assorted teas, served with Chef's Selection of two Morning Tea items



*Prices Valid till 31st December 2025

Prices do not include a private room hire fee. For complimentary room hire, minimum numbers apply. We can assist with any audio or visual requirements.

"Our menu and kitchen contains multiple allergens and foods which may cause an intolerance. Our team will make efforts to accommodate dietary requirements for your event, including the preparation of select dishes without the addition of certain allergens on request. However due to the shared production and serving environment, we cannot guarantee the complete omission of such allergens or foods which may cause an intolerance. You are responsible for ensuring all event attendees who indicate dietary requirements (including allergens and intolerances) are clearly informed of this."

ACCOMMODATION



STUDIO ROOMS

Our studio rooms offer a stylish relaxing space with all the facilities you'll need for a comfortable stay in Parramatta. With a king bed or two single beds, kitchenette and bathroom, the studio rooms provide the perfect Parramatta accommodation for couples or singles. Ideally suited to corporate travellers, these rooms also feature a workspace with desk, and wireless broadband. All rooms have air-conditioning and in-room entertainment featuring wall-hung LCD TV.

EXECUTIVE SPA ROOMS

Our spacious Executive Spa Rooms provide all the facilities of the Studio Rooms with the added luxury of a relaxing two-person spa bath. Ideally suited to couples, or singles looking for a little more space and comfort, each room also features a plush queen-size bed, as well as kitchenette for light in-room dining and a bathroom. Providing the perfect place to kick back and relax during your stay in Parramatta, our Executive Spa Rooms feature wall-hung LCD TV.



ONE BEDROOM APARTMENTS

Ideally suited to couples looking for extra space, or for longer Parramatta visits, our One Bedroom Apartments are stylish, comfortable and spacious. The light and airy One Bedroom Apartments have a queen bed, kitchenette and bathroom, and also feature a dedicated lounge and dining area as well as a balcony. With a wall-mounted LCD TV, as well as in-room broadband access, there's plenty to keep you entertained while you kick back and recharge your batteries.

ONE BEDROOM EXECUTIVE SPA APARTMENTS

Offering a high level of comfort for singles or couples, the One Bedroom Executive Spa Apartments features a plush queen size bed, as well as a separate bathroom, kitchenette, balcony and spacious living and dining areas. Mantra Parramatta's One Bedroom Executive Spa Apartments come with the added bonus of a two-person spa bath to relax in at the end of a long day.



COMFORT SUITES

Offering contemporary apartment style accommodation, with a separate bedroom featuring a plush king size bed, our Comfort Suites are ideal for singles and couples. Also featuring a balcony, and dedicated living and dining area and a LCD TV, the Comfort Suites provide the perfect space and facilities for relaxation during your visit to Parramatta

mantra

EVENTS YOUR WAY

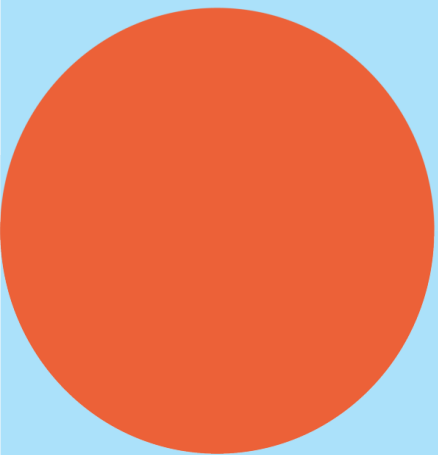

MANTRA PARRAMATTA
CNR PARKES STREET & VALENTINE AVENUE PARRAMATTA NSW 2160
T. (02) 96851600 | Conference: (02) 96851607
E. parramatta.events@mantra.com.au
W. mantraparramattahotel.com.au
W. accorevents.com/venues/mantra-parramatta

